

NEWLINK

Cabling Systems

Newlink Server Racks

Characteristics:

- Flat packing
- Exquisite design with precise dimensions and craftsmanship
- Adjustable feet and heavy-duty castors
- Cable entry on the top cover and bottom panel with adjustable sizes
- Optional installation of plinth to enable cabinets fixation, under-base cable entry/ventilation
- Efficient and reliable cabinet connection by baying kit
- Removable side panels for easy maintenance
- Comply with ANSI/EIA, RS-310-D, IEC60297-2, DIN41494; PART1, DIN41494; PART7
- Material: SPCC Cold Rolled Steel
- 19" rails: 2.0mm, side panel: 1.0mm, others: 1.2mm
- Loading Capacity: 800Kg
- IP rating: IP20

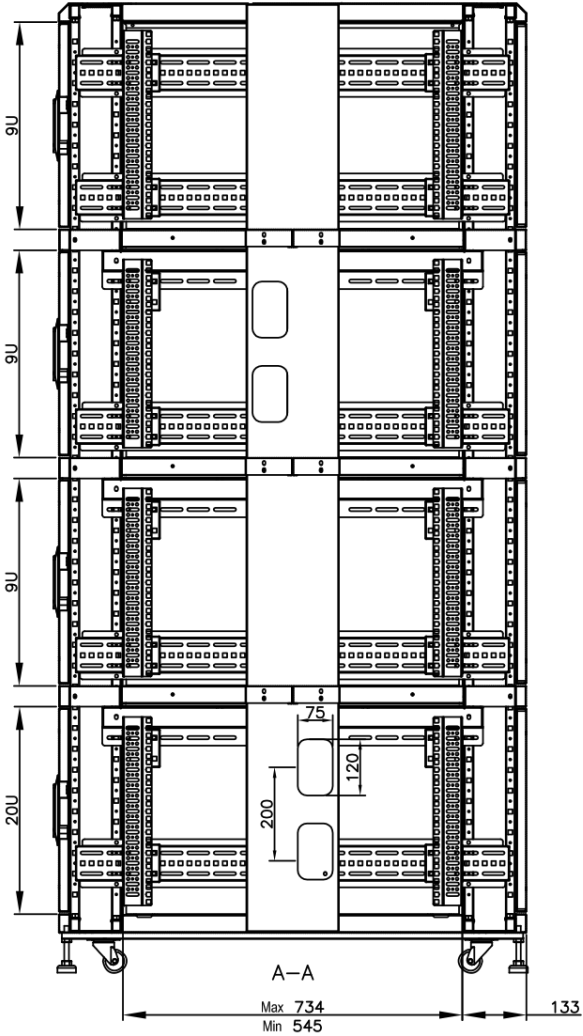
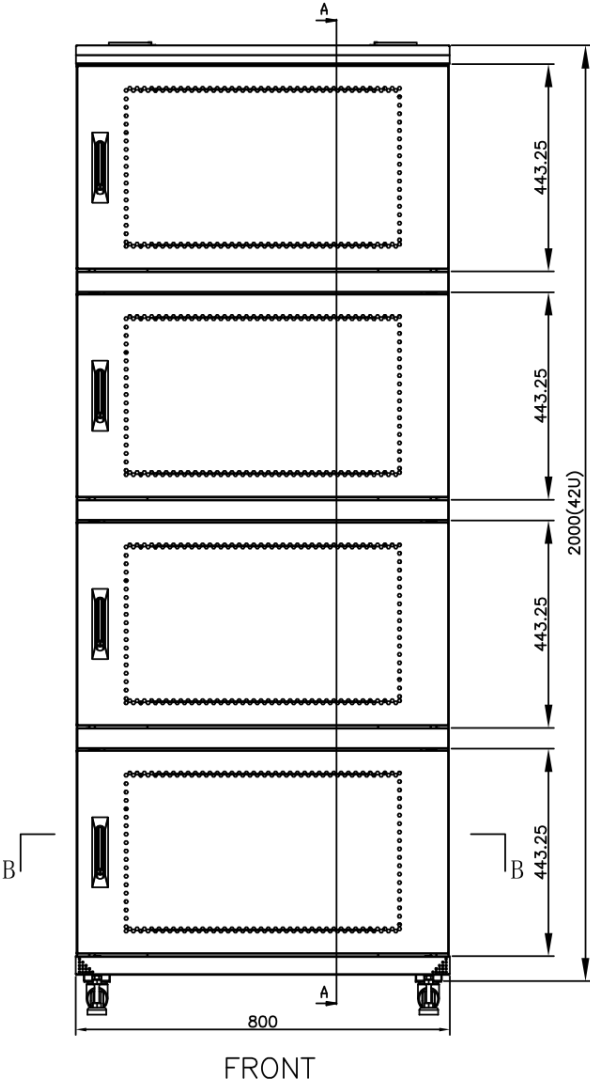

NEWLINK

Cabling Systems

Newlink Server Racks

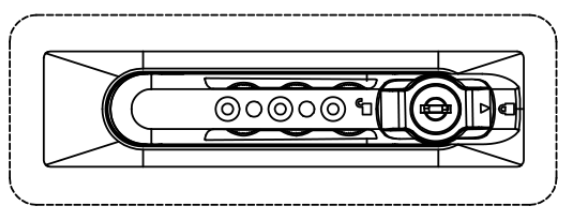
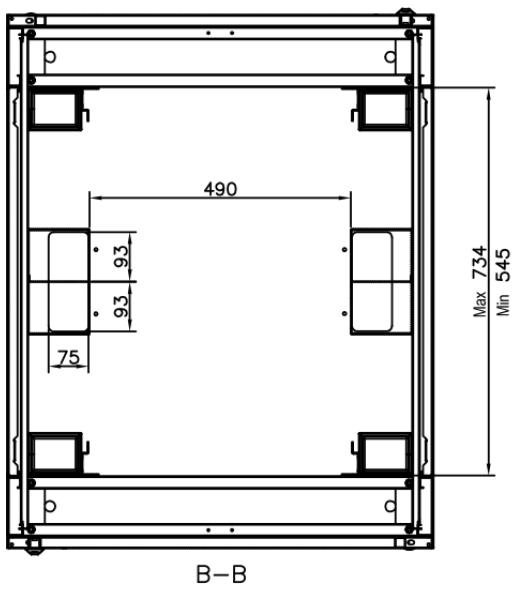
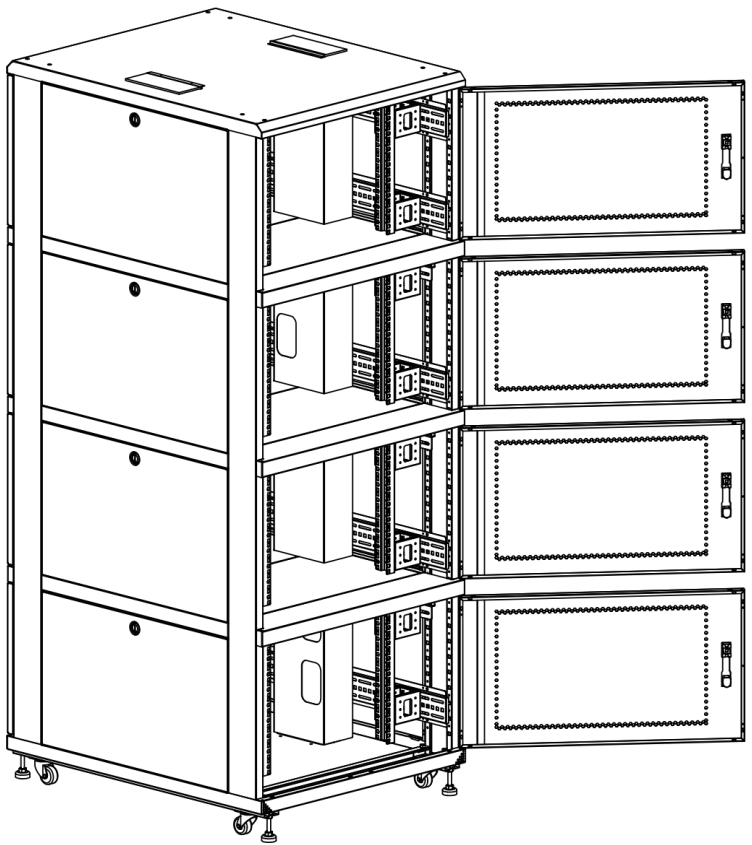
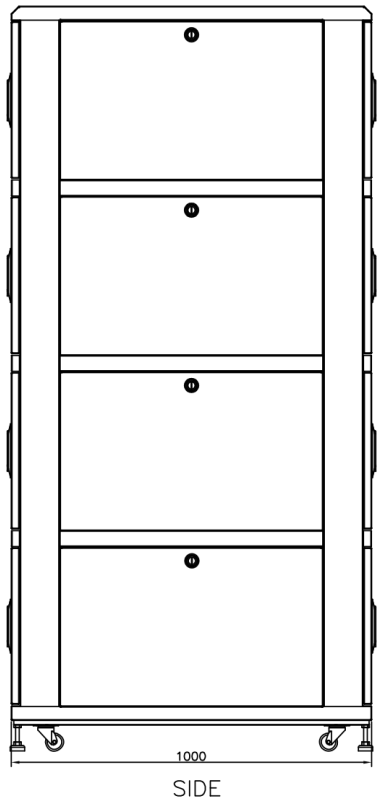

Ordering Information:

| Part number | Description |
|--------------------|--------------------------|
| NEW-0978111 | Server Rack 600*1000*42U |
| NEW-0984111 | Server Rack 600*1000*47U |
| NEW-0978222 | Server Rack 800*1000*42U |
| NEW-0984222 | Server Rack 800*1000*47U |